

LA PARADE DU VIVANT MOVES THROUGH THE CITY!

Our proposal imagines an urban ecological spectacle that enlivens the city throughout summer. A traveling procession — La Parade du Vivant — moves across Geneva, unfolding into unique spaces of socio-ecological encounter at 15 different urban locations over 16 weeks. But the parade is more than the sum of temporary installations. The act of moving — the procession itself — becomes an urban ritual that connects, inspires, and mobilizes the city's residents. Rooted in the long tradition of civic processions that shape urban identity and collective memory, our proposal places non-human life at its center. We pay tribute to the animals and plants that co-inhabit Geneva, carrying them proudly through the streets. Each week, the parade halts at a different urban site — often underused or heavily mineralized — and temporarily transforms it into a vibrant green meeting place. These interventions reveal the transformative power of vegetation and the latent potential of public space. The green wagons, conceived as mobile landscape compositions, not only offer immersive social and sensory experiences, but also serve as real refuges for urban fauna, providing shelter, nourishment, and water — miniature ecosystems on wheels. Through this weekly rhythm, a new urban culture around nature begins to emerge — one that strengthens our emotional connection to the ecosystems we live among, and fosters a more integrated and reciprocal relationship between the city and the living world.

A LANDSCAPE-BASED APPROACH

The design of the trailers is inspired by the distinctive bio-physical landscapes of the Geneva region. Historically, urban greenery has often followed generic horticultural trends. Today, we see an urgent call to reintegrate native ecological communities into the urban context. To do so, we must understand these landscapes in relation to Geneva's urban bioclimatic conditions. We draw from four landscape typologies. These are familiar places for Genevans, and the parade allows them to reappear — reimagined in the heart of the city.

1. the forested complexes of Versoix, nestled against the Jura Mountains
2. the Alondon Valley and its tributaries
3. the dramatic limestone slopes of Le Salève
4. the alluvial zones around Lac Léman and the Rhône river



The characteristic landscapes of the Geneva region serve as inspiration for the parade's wagons.



**biorama 1. Versoix forest landscape**  
English oak, European hornbeam, Silver birch, Common hazel, Lily fern, Tall fescue, Purple thistle, Dog's mercury



**biorama 2. the Alondon Valley landscape**  
Sweet chestnut, Black locust, Willow species, Black alder, Wild orchids, Himalayan balsam, Stinging nettle, Giant goldfinch



**biorama 3. Le Salève landscape**  
European beech, Silver fir, Norway spruce, Common juniper, Field sownwood, True lavender, Common thyme, Grey-leaved olive



**biorama 4. the Rhône river landscape**  
European larch, Silver fir, Norway spruce, European hazelberry, Peppercorn, White horsehoof, Mountain aspen, Yellow gentian

TEN LANDSCAPE TRAILERS

The parade consists of ten mobile trailers. Eight of them are designed as moving biotopes, each representing a characteristic landscape from the Geneva region. We call them 'bioramas' — mobile ecosystems that showcase local biodiversity and invite public interaction. These bioramas are conceived as self-sustaining living communities, resilient to urban stressors such as drought, wind, and human activity. Each of the four landscape types is represented by two distinct trailers.

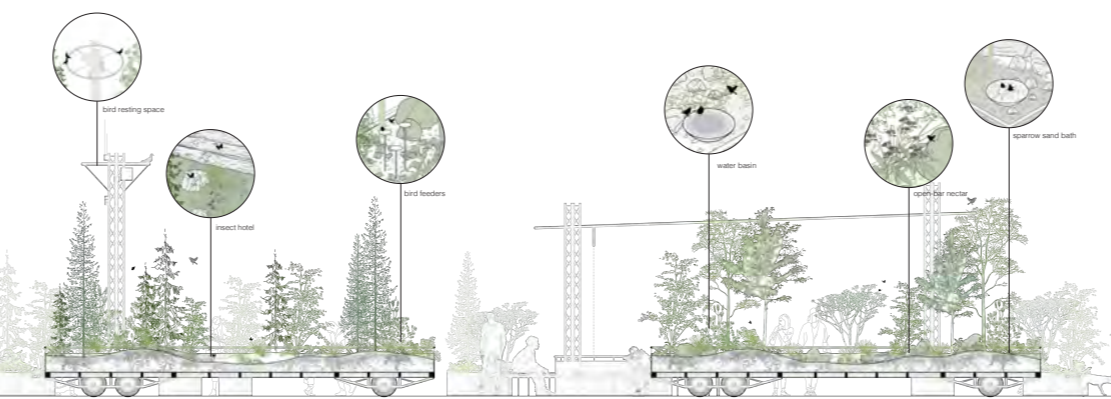

Overview of the urban fauna support measures

The aqueduct system collects rainwater from nearby rooftops and channels it into a water basin, which is then used to irrigate plants during dry periods. The integrated climate station provides real-time data on temperature, humidity, and wind, helping monitor microclimatic effects in each location.

In addition to the eight green trailers, we propose two 'podium trailers' — social stages for encounter and activation. These serve as platforms for relaxation (with hammocks), play (swings, TikTok backdrops), or events (talks, performances, and workshops). During transit, they double as transport units for the mobile planting containers and modular furniture.

MOVING TO THE RHYTHM OF SUMMER

The hyper-mobile nature of the installation responds to the desire to reach 15 sites in just one summer. Using trailer-mounted modules allows for quick and simple installation. Each site hosts the installation for one week. The calendar and overview show the parade's various stops in relation to other citywide events. Every Friday afternoon, the parade sets off to a new location — a performative moment in itself. The procession moves slowly through the streets, inviting residents to walk or cycle alongside. The journey begins and ends with a festive event at Plaine de Plainpalais. Citizens can track the route online — and experience a real-time celebration of urban life, ecology, and collective movement.

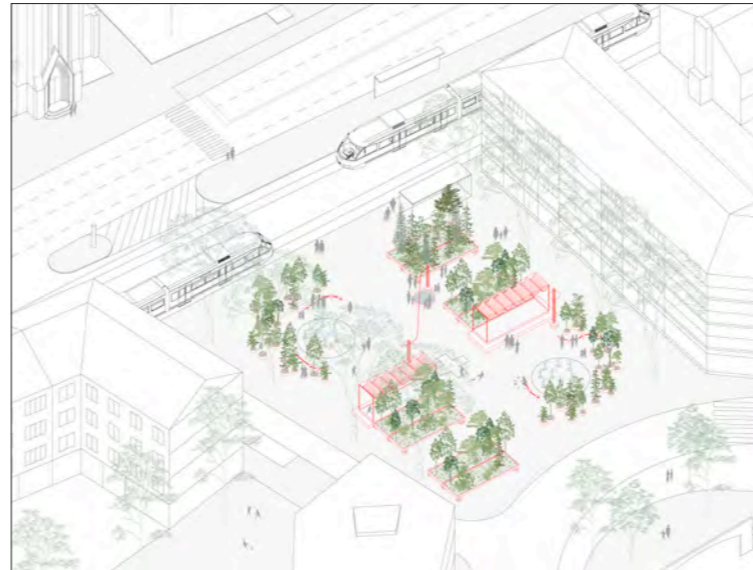
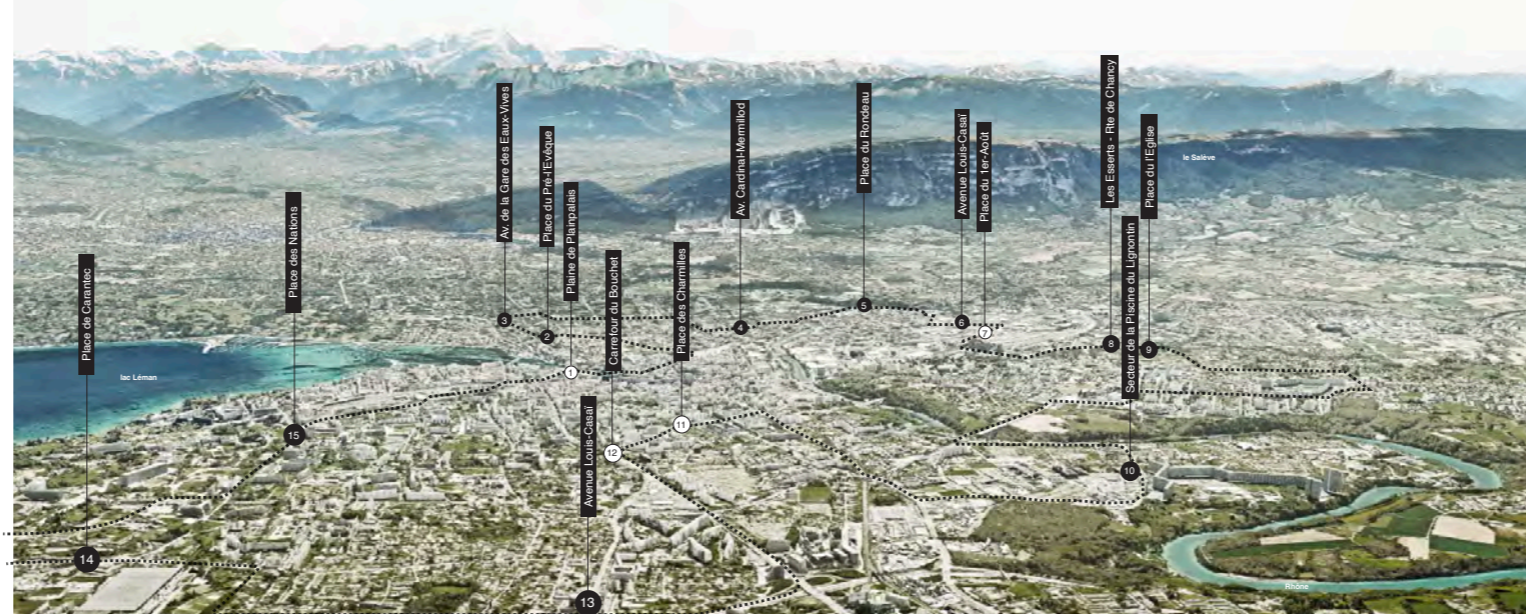

PLACE DU IER-AOÛT, LANCY (7)

Redesigned in 2016, this square has become a vibrant community hub in Grand-Lancy. Two podium trailers create a stage oriented toward the existing fountains, animating the public space with performances and gatherings. The green trailers are strategically placed to form intimate, shaded areas for meeting and relaxation. Rainwater from surrounding rooftops is collected in integrated tanks, sustaining lush micro-ecosystems throughout the site. The result is a cool, green oasis at the heart of the neighborhood — and on Wednesday, the stage comes alive with 'Créatures Urbaines,' a playful and inspiring children's show celebrating urban biodiversity.



PLACE DES CHARMILLES (11)

A dynamic public space surrounded by mixed-use buildings and major traffic arteries, Place des Charmilles serves as a gateway to central Geneva—but its current form is car-dominated, fragmented, and overwhelmingly mineral. By closing one segment of the intersection, we reclaim a generous pedestrian plaza. A central podium trailer becomes the focal point for activity, while green trailers provide a buffer from traffic, softening the space and introducing pockets of shade and greenery. The result is a vibrant outdoor venue—an ideal setting for open-air concerts and events that invite residents to reimagine the square as a people-first, lively urban space.

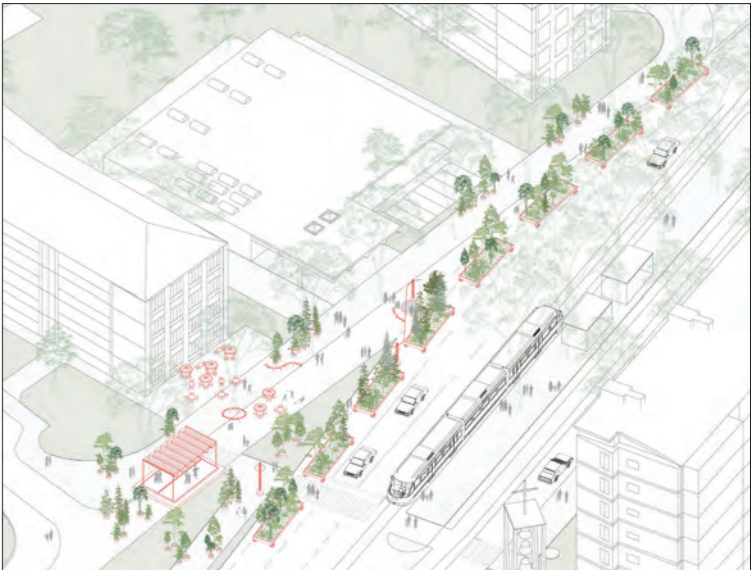

CARREFOUR DU BOUCHET (12)

This busy crossroads connects Route de Meyrin and Avenue Casai — a critical axis for traffic in northern Geneva. During the quieter summer season, we propose temporarily closing one traffic lane, transforming Carrefour du Bouchet into a long, linear park. This ephemeral green corridor links the School of Vocal Arts, a religious center, and a popular tea-room. With café terraces, play zones, and nature-based seating areas, the installation reclaims space for humans and nature alike. The eastern end culminates in the neighborhood stage, inviting gatherings and events in a space usually claimed by cars.

MATERIALS AND CIRCULARITY

The installations are made from simple materials and are modular in design. The green wagons, for example, are built on basic industrial trailers that can be dismantled after use. The furniture is also modular and reusable. Thanks to this modular approach, the installations can be optimally adapted to the specific conditions of each location. We opt for a combination of an industrial look, using galvanized steel and painted steel (in white or an accent color), which gives the whole a refined character.



Simulated the 1600L and 500L installation on Place de Plainpalais. Each setup is designed to make the most of the surrounding buildings, such as utilizing the perspective towards the church.



Each Friday, the Parade du Vivant travels to a new neighborhood, the procession discovers its unique landscape, and mobilizes the city's residents.



The route of the parade crosses the entire city, at times following the green network and passing by key social gathering points.

# GENÈVE - LA PARADE DU VIVANT

Europan 18

**La Parade du Vivant** is a traveling urban spectacle that brings together ecological imagination and civic ritual. Over the course of 16 weeks, a procession of mobile landscape trailers transforms 15 sites across Geneva into temporary spaces of nature, encounter, and celebration. Each week, the parade halts at a different underused or mineralized urban location, where it unfolds into a lush and inviting environment — part garden, part forum, part ecological performance. But more than the sum of its installations, *the act of moving* becomes a ritual in itself: a slow, festive procession that links neighborhoods, fosters public participation, and celebrates our relationship with the living world.

Rooted in the long tradition of civic parades that shape urban identity and collective memory, the Parade places **non-human life** at its symbolic and physical center. The plants, animals, and ecosystems that quietly inhabit Geneva are now brought into view — proudly paraded through the streets. These mobile interventions reveal the transformative power of vegetation and the latent potential of public space to become more alive, more inclusive, and more climate-adaptive. Each trailer becomes a miniature ecosystem, offering shelter, nourishment, and water to birds, insects, and other urban fauna — while inviting residents to rest, play, and gather.



Figure 1 The parade route crosses the entire city, linking key mobility nodes and segments of the urban green network

## TEN LANDSCAPE TRAILERS

The parade consists of ten mobile trailers. Eight of them are designed as moving biotopes, each representing a characteristic landscape from the Geneva region. We call them ‘**bioramas**’ — mobile ecosystems that showcase local biodiversity and invite public interaction. These bioramas are conceived as self-sustaining living communities, resilient to urban stressors such as drought, wind, and human activity. Each of the four landscape types is represented by two distinct trailers. Other elements — the aqueduct, water basin, stack of tree trunks, climate station, urban furniture, planting containers, and information panels — foster public engagement and raise ecological awareness.

The aqueduct system collects rainwater from nearby rooftops and channels it into a water basin, which is then used to irrigate plants during dry periods. The integrated climate station provides real-time data on temperature, humidity, and wind, helping monitor microclimatic effects in each location. In addition to the eight green trailers, we propose two “**podium trailers**” — social stages for encounter and activation. These serve as platforms for relaxation (with hammocks), play (swings, TikTok backdrops), or events (talks, performances, and workshops). During transit, they double as transport units for the mobile planting containers and modular furniture.



**biorama 1. Versoix forest landscape**

*English oak, European hornbeam, Silver birch, Common hazel  
Lady fern, Tall fescue, Purple lettuce, Dog's mercury*



**biorama 2. the Allondon Valley landscape**

*Sweet chestnut, Black locust, Willow species, Black alder  
Wild orchids, Himalayan balsam, Stinging nettle, Giant goldenrod*

*Figure 2 Example of two landscape trailers or ‘bioramas’ representing two characteristic landscapes from the Geneva region*

## A LANDSCAPE-BASED APPROACH

The parade includes ten trailers. The design of the trailers draws from four characteristic biophysical landscapes of the Geneva region: the forests of Versoix, the Allondon valley, the Rhône plain, and the slopes of the Salève. These familiar regional ecologies are reimagined as “bioramas” — curated, living fragments of nature mounted on industrial trailers. Historically, urban greenery has often followed ornamental or standardized planting schemes. La Parade du Vivant instead reclaims landscape as a site-specific, meaningful, and ecologically grounded practice — reconnecting the city to its own bioclimatic context.

## MOVING TO THE RHYTHM OF SUMMER

The hyper-mobile nature of the installation allows it to reach 15 locations over the summer season. Each Friday afternoon, the parade departs for a new site — a performative journey that invites citizens to walk, cycle, or observe along the route. These weekly movements become moments of civic imagination, tracing a path that connects green corridors, neighborhood centers, and dense urban intersections. The journey begins and ends at **Plaine de Plainpalais**, where the full fleet of trailers gathers in a festive opening and closing event. Citizens can follow the parade’s itinerary online, encounter it in their daily routes, or join the program at any point.



Figure 3 Installation of the parade at Plaine de Plainpalais. The parade unfolds in a vibrant urban oasis with plant containers, urban furniture etc.

## THREE URBAN SCENARIOS

To demonstrate the flexibility of the design, we propose tailored interventions for three contrasting sites. At **Place des Charmilles**, a traffic-dominated node is reimagined as a pedestrian square, with the podium trailer at its center and green trailers buffering the surrounding streets — creating space for open-air concerts and spontaneous social use. At **Carrefour du Bouchet**, a lane closure transforms a busy junction into a linear park connecting cultural anchors and everyday amenities, from the School of Vocal Arts to a neighborhood tea-room. Café terraces, nature zones, and play areas line the route, culminating in a shaded stage for community events.

These scenarios show how the modular system of *La Parade du Vivant* can adapt to various urban conditions — reclaiming space for people and non-human life, one site at a time.



*Figure 4 The place des Charmilles is transformed into a vibrant urban space including pockets of shade and greenery and a central stage for events, play and encounter.*